

FM Starpoint Combiner

100 W, 3 Pole

BAND II

10 year GUARANTEE

SPECIFICATIONS	70 mm Series	Option
FREQUENCY	87 - 108 MHz	
STANDARD ORDER	3 Poles	
APPLICATION	FM combining & Spurious suppress	
IMPEDANCE	50 Ohm	
NB RETURN LOSS (VSWR)	>23 dB (1.15)	
NB INPUT CONNECTOR	N female	N male
OUTPUT CONNECTOR	N female	N male
TEMPERATURE STABILITY	≤ 5 kHz / °C	
MAX PRODUCT TEMPERATURE	70 °C	
ENVIROMENTAL CONDITION	0 to 70 °C IP40	

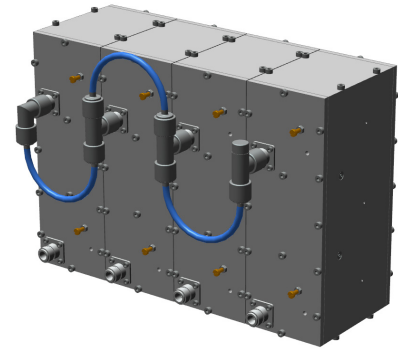

DIMENSIONS AND WEIGHT	
INDICATIVE DIMENSIONS	347 x 220 x 254 mm
L x W x H	(13.7 x 8.7 x 10 in)
STANDARD FRAME	Stand alone
OPTIONAL FRAME	19" front panel, Mounting brackets
COLOUR	Aluminium gray

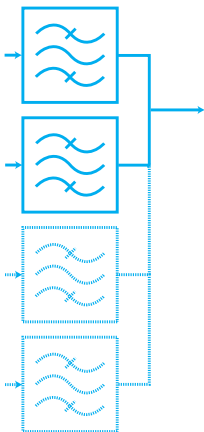

Article structure:
ARTICLE: SP23C07A-00CC-2

- SP** = Combiner Type
- 2** = Frequency band
- 3** = Number of poles
- C** = Cavity based
- 07** = Cavity size
- A** = Version
- 0** = Number of cross coupling
0 = without
- 0** = Coating
0 = Without coating
- C** = Narrowband connection
C= N female, D= N male
- C** = Output connection
C= N female, D= N male
- 2** = Number of inputs

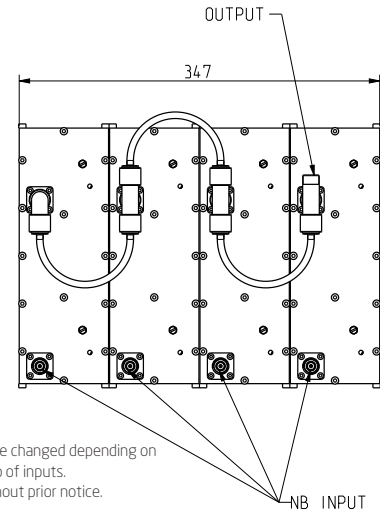
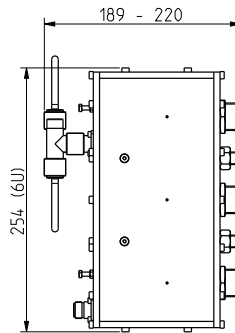

Example of design, may be changed depending on channel allocation and No of inputs. Subjected to change without prior notice.

ARTICLE	SP23C07x-00xx-2		SP23C07x-00xx-3		SP23C07x-00xx-4	
NUMER OF INPUTS	2		3		4	
MIN CHANNEL SPACING	2.2 MHz	1.0 MHz	2.2 MHz	1.0 MHz	2.2 MHz	1.0 MHz
MAX INPUT POWER / INPUT	100 W	100 W	100 W	100 W	100 W	100 W
INSERTION LOSS (dB)						
Centre frequency	<1.2	<2.5	<1.2	<2.5	<1.3	<2.6
±150 kHz	<1.2	<2.7	<1.2	<2.7	<1.3	<2.8
ISOLATION BETWEEN INPUTS						
Input frequency spacing						
±1.0 MHz	-	>30 dB	-	>30 dB	-	>30 dB
±1.2 MHz	-	>30 dB	-	>30 dB	-	>30 dB
±1.5 MHz	-	>35 dB	-	>35 dB	-	>35 dB
±2.2 MHz	>30 dB	>45 dB	>30 dB	>45 dB	>30 dB	>45 dB
±3.0 MHz	>35 dB	>55 dB	>35 dB	>55 dB	>35 dB	>55 dB
±4.0 MHz	>40 dB	>60 dB	>40 dB	>60 dB	>40 dB	>60 dB
±5.0 MHz	>45 dB	>65 dB	>45 dB	>65 dB	>45 dB	>65 dB
±6.0 MHz	>50 dB	>70 dB	>50 dB	>70 dB	>50 dB	>70 dB
±8.0 MHz	>55 dB	>75 dB	>55 dB	>75 dB	>55 dB	>75 dB
WEIGHT	7 kg (15.4 lb)		10 kg (22.0 lb)		14 kg (30.9 lb)	

* Data in table is typical data. at 100 MHz. The combiner can be tuned for other specifications or bandwidth. Please contact us for a designed specification.

** All average power values and technical data refer to an ambient temperature of +20 °C with normal airflow. The product can have a maximum surface temperature of +70 °C. Maximum power capacity may be lower depending on channel allocation. Data are subjected to change without prior notice.