

FM Constant Impedance Combiner

6 kW, 3 Pole

BAND II

10 year GUARANTEE

SPECIFICATIONS	110 mm Series	Option
FREQUENCY	87 - 108 MHz	
STANDARD ORDER	3 Poles with heat sink	with temperature compensation, without heat sink
APPLICATION	FM combining & Spurious suppress	
IMPEDANCE	50 Ohm	
NB RETURN LOSS (VSWR)	>30 dB (1.07)	
WB RETURN LOSS (VSWR)	>30 dB (1.07)	
MAX OUTPUT POWER RATING**	15 kW rms (1 5/8" output)	
NB INPUT CONNECTOR	1 5/8" unflange	N female/ male, 7/16 female/ male 7/8" unflange/ flange, 1 5/8" flange
WB INPUT CONNECTOR	1 5/8" unflange	N female/ male, 7/16 female/ male 7/8" unflange/ flange, 1 5/8" flange
OUTPUT CONNECTOR	1 5/8" unflange	N female/ male, 7/16 female/ male 7/8" unflange/ flange, 1 5/8" flange
TEMPERATURE STABILITY	≤ 3 kHz / °C (without temp. comp.)	≤ 0.5 kHz / °C (with temp. comp.)
MAX PRODUCT TEMPERATURE	70 °C	
ENVIROMENTAL CONDITION	0 to 70 °C IP40	

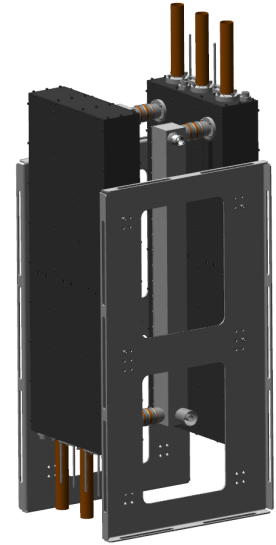

DIMENSIONS AND WEIGHT

DIMENSIONS	500 x 384 x 1320 mm
L x W x H	(19.7 x 15.1 x 52 in)
WEIGHT	50 kg (110.2 lb)
STANDARD FRAME	Stand alone
COLOUR	Black and aluminium

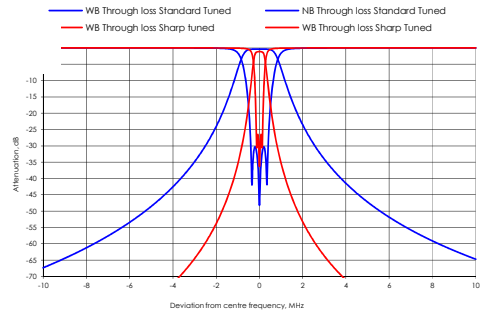
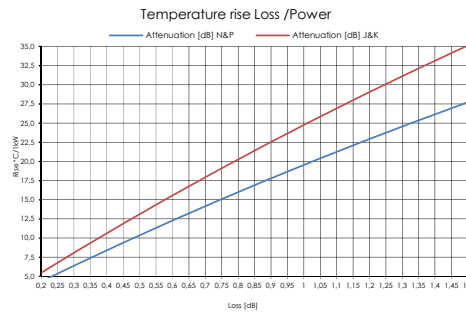

TYPICAL DATA*	STANDARD TUNED	SHARP TUNED
ARTICLE NO	CI23C11x-0PAAxxx	CI23C11x-0PAAxxx
NB INSERTION LOSS		
Centre frequency	<0.45 dB	<1.25 dB
Effective passband @ ± 200 KHz	<0.45 dB	<1.25 dB
± 150 KHz	<0.45 dB	<1.45 dB
± 200 KHz	<0.45 dB	<1.95 dB
± 0.6 MHz	>0.7 dB	>20.0 dB
± 1.0 MHz	>6.0 dB	>33.0 dB
± 2.0 MHz	>22.0 dB	>50.0 dB
± 2.5 MHz	>28.0 dB	>55.0 dB
NB GOUPELAY VARIATION		
(typical)		
± 150 KHz	<6 ns (5 ns)	<215 ns (210 ns)
± 200 KHz	<10 ns (8 ns)	<385 ns (380 ns)
WB INSERTION LOSS		
± 0.4 MHz	-	<1.05 dB
± 0.6 MHz	-	<0.35 dB
± 0.8 MHz	-	<0.20 dB
± 1.0 MHz	-	<0.15 dB
± 1.5 MHz	<0.35 dB	<0.10 dB
± 2.0 MHz	<0.15 dB	<0.10 dB
± 3.0 MHz	<0.10 dB	<0.10 dB
ISOLATION		
NARROWBAND - WIDEBAND	>36 dB	>36 dB
WIDEBAND - NARROWBAND @		
± 1.0 MHz	>42 dB	>69 dB
± 1.5 MHz	>51 dB	>79 dB
± 3.0 MHz	>69 dB	>96 dB
NB MAX INPUT POWER RATING**		
	6.0 kW RMS (5 kW without heat sink)	2.0 kW RMS (1.7 kW without heat sink)

Article structure: ARTICLE: CI23C11J-0PAA111

CI = Combiner Type
2 = Frequency band
3 = Number of poles
C = Cavity based
11 = Cavity size
J = Version

J = without heat sink & without temp. comp.
K = without heat sink & with temp. comp.
N = with heat sink & without temp. comp.
P = with heat sink & with temp. comp.

0 = Number of cross coupling
0 = without

P = Coating
P = blackpainted

A = Narrowband coupler
A = 60mm

A = Wideband coupler
A = 60mm

1 = Narrowband connection
C = N female, *D* = N male
A = 7/16 female, *B* = 7/16 male
7 = 7/8" unflange, *J* = 7/8" flange
1 = 1 5/8" unflange, *E* = 1 5/8" flange

1 = Wideband connection
C = N female, *D* = N male
A = 7/16 female, *B* = 7/16 male
7 = 7/8" unflange, *J* = 7/8" flange
1 = 1 5/8" unflange, *E* = 1 5/8" flange

1 = Output connection
C = N female, *D* = N male
A = 7/16 female, *B* = 7/16 male
7 = 7/8" unflange, *J* = 7/8" flange
1 = 1 5/8" unflange, *E* = 1 5/8" flange

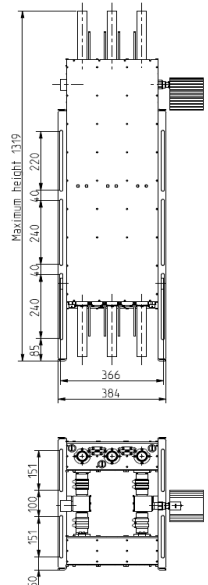

* Data in table is typical data. at 100 MHz. The combiner can be tuned for other specifications or bandwidth. Please contact us for a designed specification.

** All average power values and technical data refer to an ambient temperature of +20 °C with normal airflow. The product can have a maximum surface temperature of +70 °C. Maximum power capacity may be lower depending on channel allocation. Data are subjected to change without prior notice.